

DE - Doppio effetto / DE - Double acting

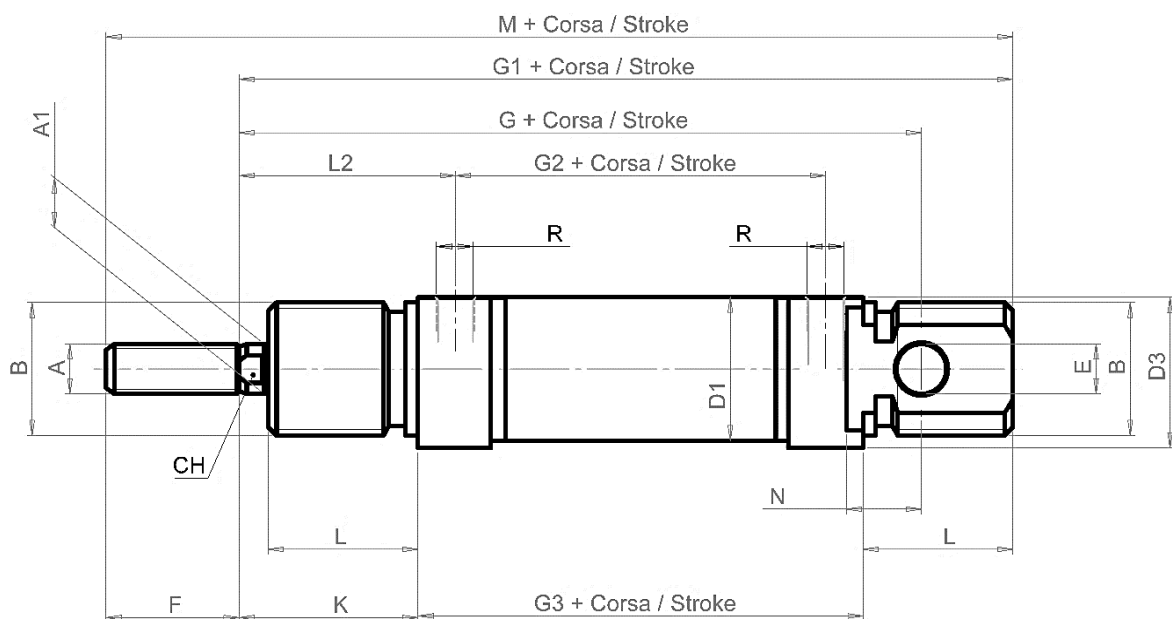

Ø mm	A	A1	B	C	D	D1	D3	E	F	G	G1	G2	G3	K	L	L2	N	CH	R	M
8	M4	4	M12 x 1,25	16	8	9,27	15	4	12	64	74	36	46	16	12	21	6	/	M5	86
10	M4	4	M12 x 1,25	16	8	11,27	15	4	12	64	74	36	46	16	12	21	6	/	M5	86
12	M6	6	M16 x 1,5	19	12	13,27	18	6	16	75	88	38	48	22	18	27	9	5	M5	104
16	M6	6	M16 x 1,5	19	12	17,27	18	6	16	82	93	44	53	22	18	27	9	5	M5	109
20	M8	8	M22 x 1,5	27	16	21,27	25,5	8	20	95	111	51,5	67	24	20	32	12	7	1/8"	131
25	M10 x 1,25	10	M22 x 1,5	30	16	26,5	28,5	8	22	104	118	52	68	28	22	36	12	9	1/8"	140

Corse disponibili / Available stroke

Corsa / Stroke	Ø8	Ø10	Ø12	Ø16	Ø20	Ø25
10	X	X	X	X	X	X
25	X	X	X	X	X	X
50	X	X	X	X	X	X
80	X	X	X	X	X	X
100	X	X	X	X	X	X
125	X	X	X	X	X	X
160	X	X	X	X	X	X
200	X	X	X	X	X	X
250			X	X	X	X
300			X	X	X	X
320				X	X	X
400				X	X	X
500				X	X	X